

Part Number: F12340

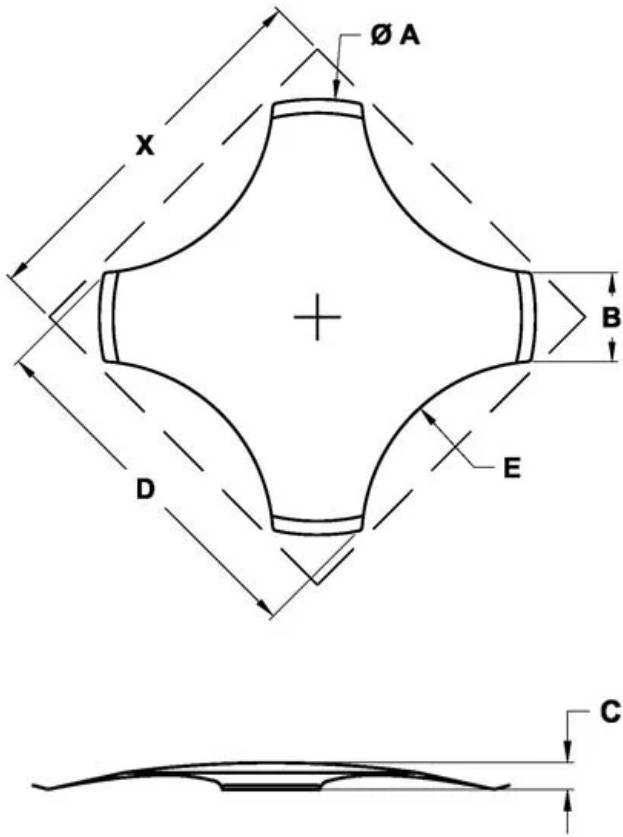

Dim. A	12mm (0.472")
Dim. B	2.49mm (0.098")
Dim. C	0.71mm (0.028")
Dim. D	9.96mm (0.392")
Dim. E	5.00mm (0.197")
Dim. X (dome cavity)	10.67mm (0.42")
Fmax/Force	340g +/- 30g, typical
Life Cycles	up to 5,000,000
Dimple	No
Contact Configuration	SPST N.O.
Switching Voltage	0.1 to 50 VDC
Switching Capacity	1 Watt
Switching Current	0.05 to 100 mA DC
Contact Bounce	<0.3ms make <0.6ms break
Base Material	SSTL
Plating	Nickel/Silver/Gold optional
Operating Temp Rating	-45 degrees C to +100 degrees C
Storage Temp Rating	-55 degrees C to +100 degrees C