

Part Number: F10340

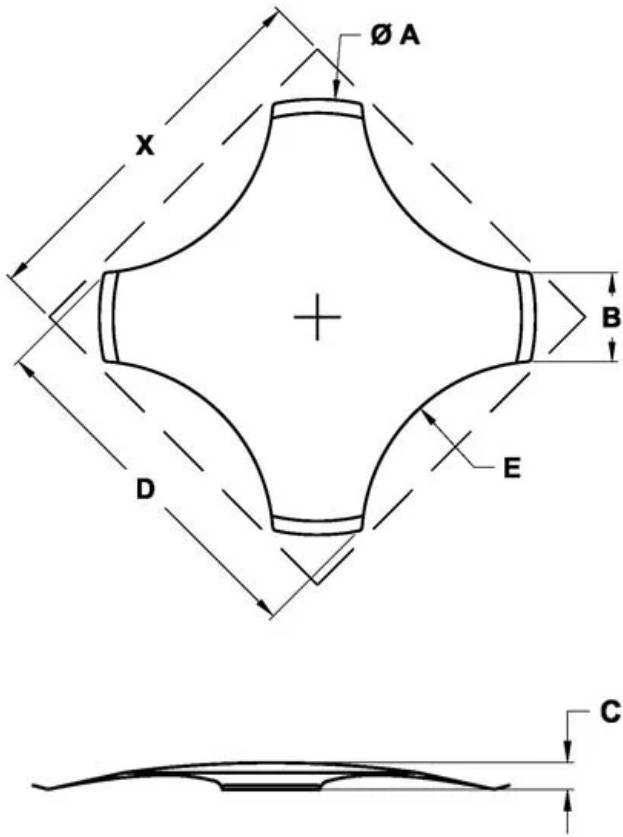

Dim. A	10mm (0.394")
Dim. B	2.29mm (0.090")
Dim. C	0.61mm (0.024")
Dim. D	8.33mm (0.328")
Dim. E	4.19mm (0.165")
Dim. X (dome cavity)	9.14mm (0.36")
Fmax/Force	340g +/- 30g, typical
Life Cycles	up to 5,000,000
Dimple	No
Contact Configuration	SPST N.O.
Switching Voltage	0.1 to 50 VDC
Switching Capacity	1 Watt
Switching Current	0.05 to 100 mA DC
Contact Bounce	<0.3ms make <0.6ms break
Base Material	SSTL
Plating	Nickel/Silver/Gold optional
Operating Temp Rating	-45 degrees C to +100 degrees C
Storage Temp Rating	-55 degrees C to +100 degrees C